

PTAC12H352-KC EXPLODED DIAGRAM - PARTS VIEW

Sales Model : PTAC12H352-KC | MWIUP-12EEN1-MK6
Power Supply 208-230V / 1ph / 60Hz

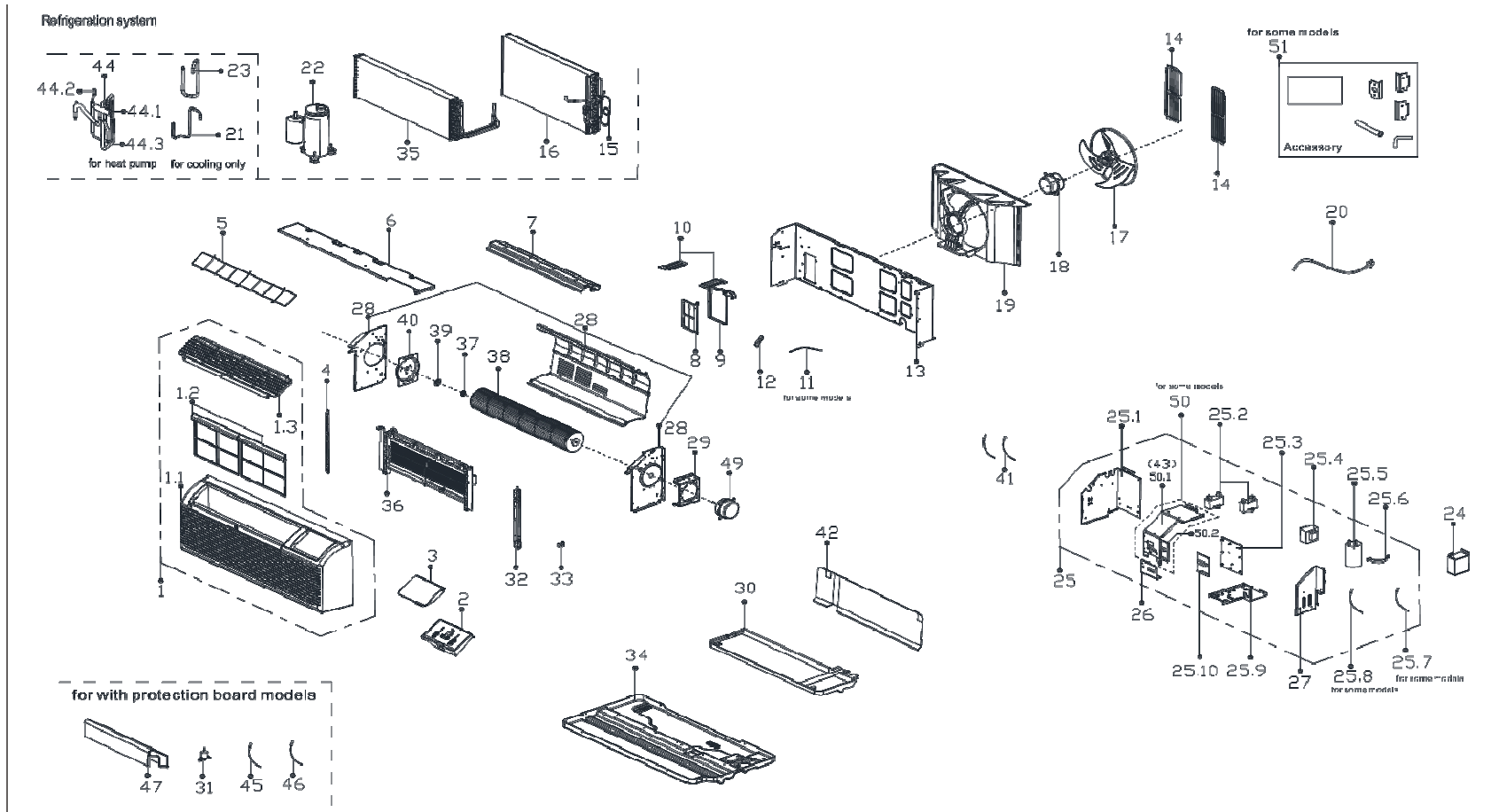

This information is to be used by qualified HVAC technicians only and is subject to revision without notice

PTAC12H352-KC - Drawing No. D6CK200803

DATE 20-08

PTAC12H352-KC - SPARE PARTS LIST

| No. | Part Number | Part Name | Specifications | Stock No. | Qty. | Price | Remarks |
|-----|-----------------|-----------------------------------|------------------|-----------|------|----------|---------------------------------|
| 1 | 12120300000261 | Panel frame subassembly | | | 1 | \$172.95 | |
| 1.1 | 121203000003185 | Panel frame | | | 1 | | |
| 1.2 | 12120300A03940 | Air filter | | | 2 | \$14.25 | |
| 1.3 | 121203000003184 | Air outlet frame | | | 1 | | |
| 2 | 17220300004350 | Display box subassembly | | | 1 | | US1-KCD45P/DN1Z.JD.WS.XS.XK1.15 |
| 3 | 12120300001399 | Control panel cover | | | 1 | \$9.15 | |
| 4 | 12220300000534 | Fixing board(left) | | | 1 | \$4.35 | |
| 5 | 12220300000533 | Rear net | | | 1 | \$24.96 | |
| 6 | 12220300000522 | Front cover | | | 1 | \$37.95 | |
| 7 | 12220300000518 | Volute shell | | | 1 | \$30.03 | |
| 8 | 12120300001288 | Filter | | | 1 | \$4.05 | |
| 9 | 12220300000262 | Fresh air door | | | 1 | \$8.40 | |
| 10 | 12220300000566 | Linker for front separating board | | | 2 | \$2.40 | |
| 12 | 12220300000312 | Connecting rod of fresh air door | | | 1 | \$0.60 | |
| 13 | 12220300000128 | Front separating board | | | 1 | \$85.51 | |
| 14 | 12220300000517 | Horizontal louver | | | 2 | \$12.84 | |
| 15 | 15120300005942 | Capillary assembly | | | 1 | | |
| 16 | 15820300002882 | Condenser assembly | | | 1 | | |
| 17 | 12100105000064 | Axial flow fan | ZL-335*102*8-3FN | | 1 | \$45.43 | |
| 18 | 11002012033914 | Single phase asynchronous motor | YKT-58-4-3L | | 1 | | |
| 19 | 12120300000552 | Rear separating | | | 1 | \$67.30 | |
| 20 | 17401202000107 | Power cord subassembly | | | 1 | \$163.20 | |
| 21 | 15120300000992 | Discharge pipe assembly | | | 1 | \$17.64 | |
| 22 | 11103010002992 | Fixed Speed Rotary Compressor | ASM103N11VEZ | | 1 | \$368.56 | |

This information is to be used by qualified HVAC technicians only and is subject to revision without notice

PTAC12H352-KC - Parts List No. P6CK200803

Above prices are subject to S&H charges

DATE 20-08

PTAC12H352-KC - SPARE PARTS LIST

| No. | Part Number | Part Name | Specifications | Stock No. | Qty. | Price | Remarks |
|------|----------------|--------------------------------------|------------------------|-----------|------|----------|-------------------------------------|
| 23 | 15120300001348 | Suction pipe assembly | | | 1 | \$50.82 | |
| 24 | 12220300000277 | Line Board of Electrical Control Box | | | 1 | \$9.60 | |
| 25 | 17220300004230 | Electronic control box subassembly | | | 1 | | |
| 25.1 | 12220300000278 | Rear Plate of Electrical Control Box | | | 1 | \$24.60 | |
| 25.2 | 17400101000084 | Fan motor capacitor | 3uF/450V-P2 | | 1 | \$14.70 | |
| 25.2 | 17400101000078 | Fan motor capacitor | 1uF/450V-P2 | | 1 | \$8.85 | |
| 25.3 | 12120300001401 | Main control board holder | | | 1 | \$7.35 | |
| 25.4 | 11203103000087 | Linear Transformer | TT220-EI48-24/80-F1 | | 1 | \$71.20 | |
| 25.5 | 17400103000055 | Capacitor of compressor | 35uF/450V-50-P2(2000h) | | 1 | \$29.48 | |
| 25.6 | 12200203000018 | Capacitor clip | | | 1 | \$0.60 | |
| 25.9 | 12220300000274 | Base Plate of E-Parts Box | | | 1 | \$12.30 | |
| 25.1 | 17120300004110 | Main control board subassembly | | | 1 | | US1-KCD35P/DN1Z-IPB.JD.WS.NK.NK1.11 |
| 26 | 12220300A00131 | Dialing Cover of E-Parts Box | | | 1 | \$1.80 | |
| 27 | 12220300000303 | Cover of electronic control box | | | 1 | \$13.50 | |
| 28 | 12220300000513 | Supporter subassembly of air passage | | | 1 | \$92.80 | |
| 29 | 12220300000449 | Supporter of fan motor | | | 1 | \$13.50 | |
| 30 | 12820300000028 | Condenser water tray | | | 1 | \$12.84 | |
| 32 | 12220300000537 | Fixing board(right) | | | 1 | \$4.35 | |
| 33 | 12220300000560 | Hook of Panel | | | 2 | \$1.35 | |
| 34 | 12220300003659 | Chassis assembly | | | 1 | | |
| 35 | 15820300002651 | Evaporator assembly | | | 1 | | |
| 36 | 17402006000013 | Electric heater subassembly | | | 1 | \$299.76 | |
| 37 | 12622000000012 | Bearing base | | | 1 | \$1.50 | |
| 38 | 12100102000055 | Cross flow fan | GL-120*706-NX | | 1 | \$183.30 | |

This information is to be used by qualified HVAC technicians only and is subject to revision without notice

PTAC12H352-KC - Parts List No. P6CK200803

Above prices are subject to S&H charges

DATE 20-08

PTAC12H352-KC - SPARE PARTS LIST

| No. | Part Number | Part Name | Specifications | Stock No. | Qty. | Price | Remarks |
|------|----------------|---------------------------------|----------------|-----------|------|---------|--|
| 39 | 12220300000557 | Cover of Bearing bracket | | | 1 | \$1.80 | |
| 40 | 12220300000514 | Wind baffle board | | | 1 | \$9.60 | |
| 41 | 11201007003124 | Discharge Temperature Sensor | | | 1 | \$13.05 | CGQ-WD/PQ3950-L1000-XHBCP2BK-G950 |
| 41 | 11201007003427 | Discharge Temperature Sensor | | | 1 | \$11.25 | CGQ-WD/PQ3950-L500-XHBCP2BK-G480 |
| 42 | 12920300000002 | Condenser water tray | | | 1 | \$29.16 | |
| 45 | 11201007003424 | Room temperature sensor | | | 1 | \$5.70 | CGQ-WD/SW4100-L350-XHBCP2BL-P300-HT1.0 |
| 46 | 11201007003447 | Pipe Temperature Sensor | | | 1 | \$6.45 | CGQ-WD/GW4100-L350-XACP2-P250 |
| 47 | 12220300000540 | Side plate | | | 1 | \$9.00 | |
| 49 | 11002012033915 | Single phase asynchronous motor | YKT-21-6-15L | | 1 | | |
| 50 | 17122000046853 | Dial switch subassembly | | | 1 | | |
| 50.1 | 12220300000272 | Cover of electronic control box | | | 1 | \$16.44 | |
| 50.2 | 17122000047469 | Switchboard subassembly | | | 1 | | |

This information is to be used by qualified HVAC technicians only and is subject to revision without notice

PTAC12H352-KC - Parts List No. P6CK200803

Above prices are subject to S&H charges

DATE 20-08